

EMCS-557 Ceiling Speaker



The EMCS-557 6.5" Loudspeaker offers high quality performance and wide frequency response. The speaker consists of a 6" diameter dual cone type with power rating of 10 watts. The wide range of the frequency produces a sound quality with low distortion. The frequency response of this speaker is in the range from 80Hz to 20KHz resulting in a wide uniform coverage of 120 degrees thereby producing an excellent sound reproduction for vocal and music for a wider coverage area.

Features

- > Voltage 100V, Rated power 20W
- > Max. Sound Pressure Level 104 ± 2 dB, Effective Freq. Range 80Hz-20kHz
- > Made of high quality engineering plastic, long-term durability, never out of shape and colour never fade
- > Sensitivity 91 ± 2 dB, long life, clear and sonorous sound

Model	EMCS-557
Full-range Speaker / HF Driver	6.5" x 1 1" x 1
Normal Power	10W
Max Power	20W
Line Voltage	70-100V
Sensitivity (1m, 1w)	91dB
Max Sound Pressure Level (1m)	104dB
Frequency Response	80-20,000Hz
Hole for Mounting	190 x 275mm
Dimensions	305 x 220 x 110mm
Weight	2.4kg

Installation Diagram

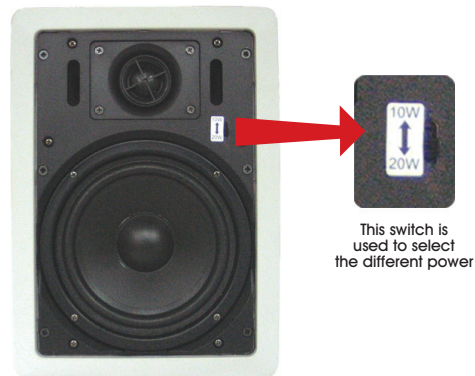

Installation

